

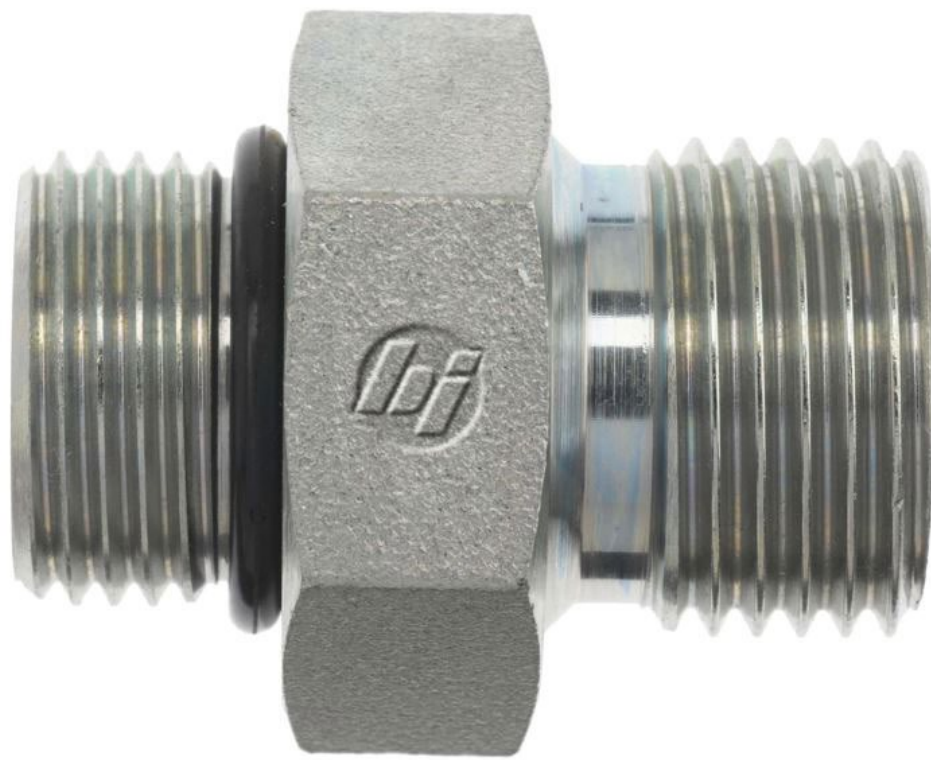

## 60-6019 - (7062)

SAE O-Ring Boss Male x BSPP Male 60 Deg Cone Less O-Ring



### **BRENNAN INDUSTRIES, EXTRAORDINARY FITTINGS**

In business for over 60 years, Brennan supplies more than 50,000 types of hydraulic fittings and adaptors in sizes ranging from 1/16 to 3 inches.

#### **Learn More at Brennan University:**

[Fittings 101](#)

[Tube Fittings Resources](#)

[Literature and Certifications](#)

**Tech Data Sheet: 71454**

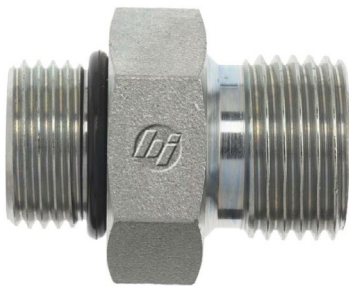

# 60-6019 - (7062)

**DESCRIPTION:**

SAE O-Ring Boss Male x BSPP  
Male 60 Deg Cone Less O-Ring

**UK SERIES:**

60-6019

**US SERIES:**

7062

**THREAD TYPE B1:**

MALE SAE O-RING BOSS

**THREAD SPECIFICATION B1:**

SAE J514

**THREAD TYPE B2:**

MALE BSPP WITH 60 DEGREE SEAT

**THREAD SPECIFICATION B2:**

60 DEG SEAT SWIVEL CONNECTION

**BODY MATERIAL:**

STEEL

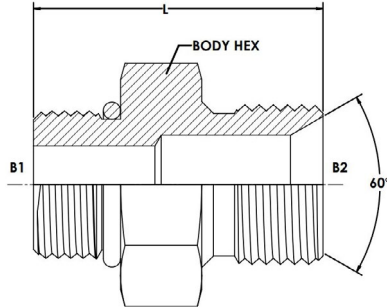

Item	THREAD SIZE B1	THREAD DRILL B1 (MM)	THREAD SIZE B2	THREAD DRILL B2 (MM)
60-6019-03-04	3/8-24	3.2	1/4-19	6.0
60-6019-04-02	7/16-20	4.4	1/8-28	4.0
60-6019-04-04	7/16-20	4.4	1/4-19	6.0
60-6019-04-06	7/16-20	4.4	3/8-19	7.9
60-6019-04-08	7/16-20	4.4	1/2-14	12.7
60-6019-04-16	7/16-20	4.4	1-11	22.0
60-6019-05-04	1/2-20	6.0	1/4-19	6.0
60-6019-05-06	1/2-20	6.0	3/8-19	7.9
60-6019-05-08	1/2-20	6.0	1/2-14	12.7
60-6019-06-04	9/16-18	6.0	1/4-19	6.0
60-6019-06-06	9/16-18	7.5	3/8-19	9.5
60-6019-06-08	9/16-18	7.5	1/2-14	12.7
60-6019-06-10	9/16-18	7.5	5/8-14	12.0
60-6019-08-04	3/4-16	9.9	1/4-19	6.0
60-6019-08-06	3/4-16	9.9	3/8-19	9.5
60-6019-08-08	3/4-16	9.9	1/2-14	12.7
60-6019-08-10	3/4-16	9.9	5/8-14	14.3
60-6019-08-12	3/4-16	9.9	3/4-14	16.7
60-6019-10-04	7/8-14	12.3	1/4-19	6.0
60-6019-10-06	7/8-14	12.3	3/8-19	9.5
60-6019-10-08	7/8-14	12.3	1/2-14	12.7
60-6019-10-10	7/8-14	12.3	5/8-14	14.3
60-6019-10-12	7/8-14	12.3	3/4-14	18.2
60-6019-10-16	7/8-14	12.3	1-11	22.0
60-6019-12-06	1-1/16-12	15.5	3/8-19	9.5
60-6019-12-08	1-1/16-12	15.5	1/2-14	12.7
60-6019-12-10	1-1/16-12	15.5	5/8-14	14.3
60-6019-12-12	1-1/16-12	15.5	3/4-14	15.5
60-6019-12-16	1-1/16-12	15.5	1-11	22.2
60-6019-14-12	1-3/16-12	18.3	3/4-14	15.5
60-6019-16-04	1-5/16-12	21.4	1/4-19	6.0
60-6019-16-08	1-5/16-12	21.4	1/2-14	12.7
60-6019-16-12	1-5/16-12	21.4	3/4-14	16.7
60-6019-16-16	1-5/16-12	21.4	1-11	21.4
60-6019-16-20	1-5/16-12	21.4	1-1/4-11	30.0
60-6019-16-24	1-5/16-12	21.4	1-1/2-11	33.0
60-6019-20-12	1-5/8-12	27.4	3/4-14	17.0
60-6019-20-16	1-5/8-12	27.4	1-11	22.2
60-6019-20-20	1-5/8-12	27.4	1-1/4-11	30.0
60-6019-20-24	1-5/8-12	27.4	1-1/2-11	33.0
60-6019-24-16	1-7/8-12	33.3	1-11	22.0
60-6019-24-20	1-7/8-12	33.3	1-1/4-11	30.0
60-6019-24-24	1-7/8-12	33.3	1-1/2-11	33.3
60-6019-24-32	1-7/8-12	33.3	2-11	45.0
60-6019-32-32	2-1/2-12	49.2	2-11	45.0