



37-4020 - (2700-LN)

JIC Male x JIC Male Bulkhead 37 Deg Cone c/w Locknut



BRENNAN INDUSTRIES, EXTRAORDINARY FITTINGS

In business for over 60 years, Brennan supplies more than 50,000 types of hydraulic fittings and adaptors in sizes ranging from 1/16 to 3 inches.

Learn More at Brennan University:

[Fittings 101](#)

[Tube Fittings Resources](#)

[Literature and Certifications](#)

Tech Data Sheet: 71419

37-4020 - (2700-LN)

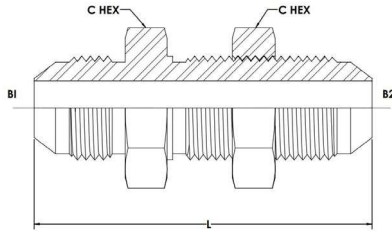

DESCRIPTION:

JIC MALE X JIC MALE BULKHEAD 37 DEG
CONE C/W LOCKNUT

UK PART NUMBER:

37-4020

US PART NUMBER:

2700-LN

Item	TUBE O.D.	B1 SAE 37 Deg	B2 SAE 37 Deg	B1 DRILL	B2 DRILL	L LGTH	C HEX	Material	LOCKNUT ASSEMBLED
37-4020-02-02	1/8	5/16-24	5/16-24	0.062	0.062	1.87	0.562	STEEL	0306-02
37-4020-03-03	3/16	3/8-24	3/8-24	0.125	0.125	1.90	0.625	STEEL	0306-03
37-4020-04-04	1/4	7/16-20	7/16-20	0.172	0.172	2.07	.688	STEEL	0306-04
37-4020-04-06	1/4	7/16-20	9/16-18	0.172	0.297	2.170	0.812	STEEL	0306-06
37-4020-05-05	5/16	1/2-20	1/2-20	0.234	0.234	2.07	0.750	STEEL	0306-05
37-4020-06-04	3/8	9/16-18	7/16-20	0.297	0.172	2.100	0.812	STEEL	0306-04
37-4020-06-06	3/8	9/16-18	9/16-18	0.297	0.297	2.18	0.812	STEEL	0306-06
37-4020-08-08	1/2	3/4-16	3/4-16	0.391	0.391	2.44	1.000	STEEL	0306-08
37-4020-10-08	7/8	7/8-14	3/4-16	0.391	0.391	2.559	0.938	STEEL	0306-08-SPL
37-4020-10-10	5/8	7/8-14	7/8-14	0.484	0.484	2.74	1.125	STEEL	0306-10
37-4020-12-12	3/4	1-1/16-12	1-1/16-12	0.609	0.609	3.09	1.375	STEEL	0306-12
37-4020-14-14	7/8	1-3/16-12	1-3/16-12	0.719	0.719	3.12	1.50	STEEL	0306-14
37-4020-16-12	1	1-5/16-12	1-1/16-12	0.844	0.609	3.14	1.625	STEEL	0306-12
37-4020-16-16	1	1-5/16-12	1-5/16-12	0.844	0.844	3.14	1.625	STEEL	0306-16
37-4020-20-20	1-1/4	1-5/8-12	1-5/8-12	1.078	1.078	3.31	1.875	STEEL	0306-20
37-4020-24-24	1-1/2	1-7/8-12	1-7/8-12	1.312	1.312	3.52	2.125	STEEL	0306-24
37-4020-32-32	2	2-1/2-12	2-1/2-12	1.781	1.781	4.20	2.750	STEEL	0306-32