



## 37-8010 - (6500-FG)

JIC Male x JIC Swivel Female 90 Deg Forged Compact Elbow  
37 Deg Cone



### **BRENNAN INDUSTRIES, EXTRAORDINARY FITTINGS**

In business for over 60 years, Brennan supplies more than 50,000 types of hydraulic fittings and adaptors in sizes ranging from 1/16 to 3 inches.

#### **Learn More at Brennan University:**

[Fittings 101](#)

[Tube Fittings Resources](#)

[Literature and Certifications](#)

**Tech Data Sheet: 71403**

# 37-8010 - (6500-FG)

## DESCRIPTION:

JIC MALE X JIC SWIVEL FEMALE 90 DEG  
FORGED COMPACT ELBOW 37 DEG CONE

## UK PART NUMBER:

37-8010

## US PART NUMBER:

6500-FG

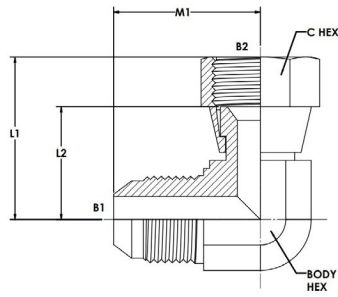

Item	TUBE O.D.	B1 SAE 37	B2 SAE 37	B1 DRILL	B2 DRILL	M LGTH	M4 LGTH	M6 LGTH	C HEX	Y FLATS	Material
37-8010-02-02	1/8	5/16-24	5/16-24	0.062	0.062	0.770	0.660	0.970	0.438	0.438	STEEL
37-8010-03-03	3/16	3/8-24	3/8-24	0.125	0.125	0.830	0.670	1.000	0.500	0.438	STEEL
37-8010-04-04	1/4	7/16-20	7/16-20	0.172	0.172	0.89	0.65	1.00	0.563	0.438	STEEL
37-8010-04-06	1/4	7/16-20	9/16-18	0.172	0.297	1.05	0.87	1.25	0.688	0.562	STEEL
37-8010-05-05	5/16	1/2-20	1/2-20	0.234	0.234	0.950	0.678	1.060	0.625	0.562	STEEL
37-8010-05-06	5/16	1/2-20	9/16-18	0.234	0.297	0.950	0.870	1.250	0.688	0.562	STEEL
37-8010-06-04	3/8	9/16-18	7/16-20	0.297	0.172	1.060	0.900	1.240	0.563	0.562	STEEL
37-8010-06-06	3/8	9/16-18	9/16-18	0.297	0.297	1.06	0.87	1.25	0.688	0.562	STEEL
37-8010-06-08	3/8	9/16-18	3/4-16	0.297	0.391	1.140	0.950	1.380	0.875	0.750	STEEL
37-8010-08-06	1/2	3/4-16	9/16-18	0.391	0.297	1.250	0.910	1.280	0.688	0.750	STEEL
37-8010-08-08	1/2	3/4-16	3/4-16	0.391	0.391	1.25	0.95	1.38	0.875	0.750	STEEL
37-8010-08-10	1/2	3/4-16	7/8-14	0.391	0.484	1.33	1.12	1.62	1.000	0.875	STEEL
37-8010-08-12	1/2	3/4-16	1-1/16-12	0.391	0.609	1.420	1.180	1.750	1.250	1.062	STEEL
37-8010-10-08	5/8	7/8-14	3/4-16	0.484	0.391	1.450	1.090	1.510	0.875	0.875	STEEL
37-8010-10-10	5/8	7/8-14	7/8-14	0.484	0.484	1.450	1.120	1.620	1.000	0.875	STEEL
37-8010-10-12	5/8	7/8-14	1-1/16-12	0.484	0.609	1.540	1.180	1.750	1.250	1.062	STEEL
37-8010-12-08	3/4	1-1/16-12	3/4-16	0.609	0.391	1.660	1.120	1.550	0.875	1.062	STEEL
37-8010-12-10	3/4	1-1/16-12	7/8-14	0.609	0.484	1.66	1.16	1.66	1.000	1.062	STEEL
37-8010-12-12	3/4	1-1/16-12	1-1/16-12	0.609	0.609	1.66	1.18	1.75	1.250	1.062	STEEL
37-8010-12-16	3/4	1-1/16-12	1-5/16-12	0.609	0.844	1.81	1.40	2.00	1.500	1.312	STEEL
37-8010-14-14	7/8	1-3/16-12	1-3/16-12	0.719	0.719	1.800	1.200	1.780	1.375	1.312	STEEL
37-8010-16-12	1	1-5/16-12	1-1/16-12	0.844	0.609	1.81	1.34	1.91	1.250	1.312	STEEL
37-8010-16-16	1	1-5/16-12	1-5/16-12	0.844	0.844	1.81	1.40	2.00	1.500	1.312	STEEL
37-8010-20-20	1-1/4	1-5/8-12	1-5/8-12	1.078	1.078	2.060	1.670	2.310	2.000	1.625	STEEL
37-8010-24-24	1 1/2	1-7/8-12	1-7/8-12	1.312	1.312	2.330	1.870	2.590	2.250	1.875	STEEL
37-8010-32-32	2	2-1/2-12	2-1/2-12	1.781	1.781	3.06	2.43	3.38	2.875	2.500	STEEL