

# 37-4140 - (7004)

JIC Male 37 Deg Cone x BSPP Swivel Female 60 Deg Cone



## **BRENNAN INDUSTRIES, EXTRAORDINARY FITTINGS**

In business for over 60 years, Brennan supplies more than 50,000 types of hydraulic fittings and adaptors in sizes ranging from 1/16 to 3 inches.

### **Learn More at Brennan University:**

[Fittings 101](#)

[Tube Fittings Resources](#)

[Literature and Certifications](#)

**Tech Data Sheet: 71393**

# 37-4140 - (7004)

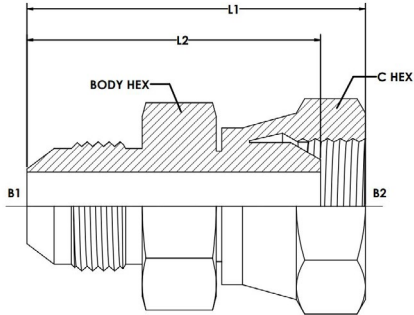

**DESCRIPTION:**

JIC Male 37 Deg Cone x BSPP Swivel Female 60 Deg Cone

**UK SERIES:**

37-4140

**US SERIES:**

7004

**THREAD TYPE B1:**

MALE JIC SAE 37 DEGREE FLARE

**THREAD SPECIFICATION B1:**

SAE J514

**THREAD TYPE B2:**

FEMALE BSPP SWIVEL

**THREAD SPECIFICATION B2:**

ISO 1179

**BODY MATERIAL:**

STEEL

Item	THREAD SIZE B1	THREAD DRILL B1 (MM)	THREAD SIZE B2	THREAD DRILL B2 (MM)	THREAD SPECIFICATION B2
37-4140-04-02	7/16-20	3.5	1/8-28	3.5	BS 5200
37-4140-04-04	7/16-20	3.8	1/4-19	3.8	BS 5200
37-4140-04-06	7/16-20	4.37	3/8-19	7.9	BS 5200
37-4140-04-08	7/16-20	4.37	1/2-14	9.93	BS 5200
37-4140-05-04	1/2-20	5.94	1/4-19	4.7	BS 5200
37-4140-05-06	1/2-20	6.0	3/8-19		BS 5200
37-4140-05-08	1/2-20	6.0	1/2-14	9.93	BS 5200
37-4140-06-04	9/16-18	7.5	1/4-19	4.7	BS 5200
37-4140-06-06	9/16-18	7.0	3/8-19	1.0	BS 5200
37-4140-06-08	9/16-18	7.5	1/2-14	9.93	BS 5200
37-4140-08-06	3/4-16	9.93	3/8-19	7.9	BS 5200
37-4140-08-08	3/4-16	9.93	1/2-14	9.93	BS 5200
37-4140-08-10	3/4-16	9.93	5/8-14	14.3	BS 5200
37-4140-08-12	3/4-16	9.93	3/4-14	16.7	BS 5200
37-4140-10-06	7/8-14	12.3	3/8-19	7.9	BS 5200
37-4140-10-08	7/8-14	12.3	1/2-14	9.93	BS 5200
37-4140-10-10	7/8-14	12.3	5/8-14	12.3	BS 5200
37-4140-10-12	7/8-14	12.3	3/4-14	16.7	BS 5200
37-4140-12-08	1-1/16-12	15.5	1/2-14	9.93	BS 5200
37-4140-12-12	1-1/16-12	15.5	3/4-14	16.7	BS 5200
37-4140-12-16	1-1/16-12	15.5	1-11	22.2	BS 5200
37-4140-12-24	1-1/16-12	15.5	1-1/2-11	33.3	BS 5200
37-4140-16-12	1-5/16-12	21.4	3/4-14	16.5	BS 5200
37-4140-16-16	1-5/16-12	20.5	1-11	20.5	BS 5200
37-4140-20-20	1-5/8-12	26.0	1-1/4-11	26.0	BS 5200
37-4140-24-24	1-7/8-12	33.3	1-1/2-11	33.3	BS 5200
37-4140-32-32	2-1/2-12	45.2	2-11	45.2	BS 5200